

Lens Specification	
Focal length	16.033mm ±5%
Back focal length	10.934mm ±5%
Mechanical back	8.539mm ±0.3mm
Aperture ratio	F/1.8 ±5%
Image size	1/3" 4.8mmX3.6mm
Magnification	-
Distortion	-0.16% (IH=3.0mm)
Angle of view at INF.	
Vertical	12.8°
Horizontal	17.0°
Diagonal	21.2°
Resolution	
Center	100LP/mm
Corner	80LP/mm
Pupil positions from the lens surface.	
Entrance pupil	8.25mm (Front lens)
Exit pupil	-13.68mm (Image plane)
Principal points from the lens surface.	
Object space	5.494mm (Front lens)
Image space	-16.033mm (Image plane)
Coating (λ=546nm)	
All surfaces are antireflection coated. MgF2 single coated.	

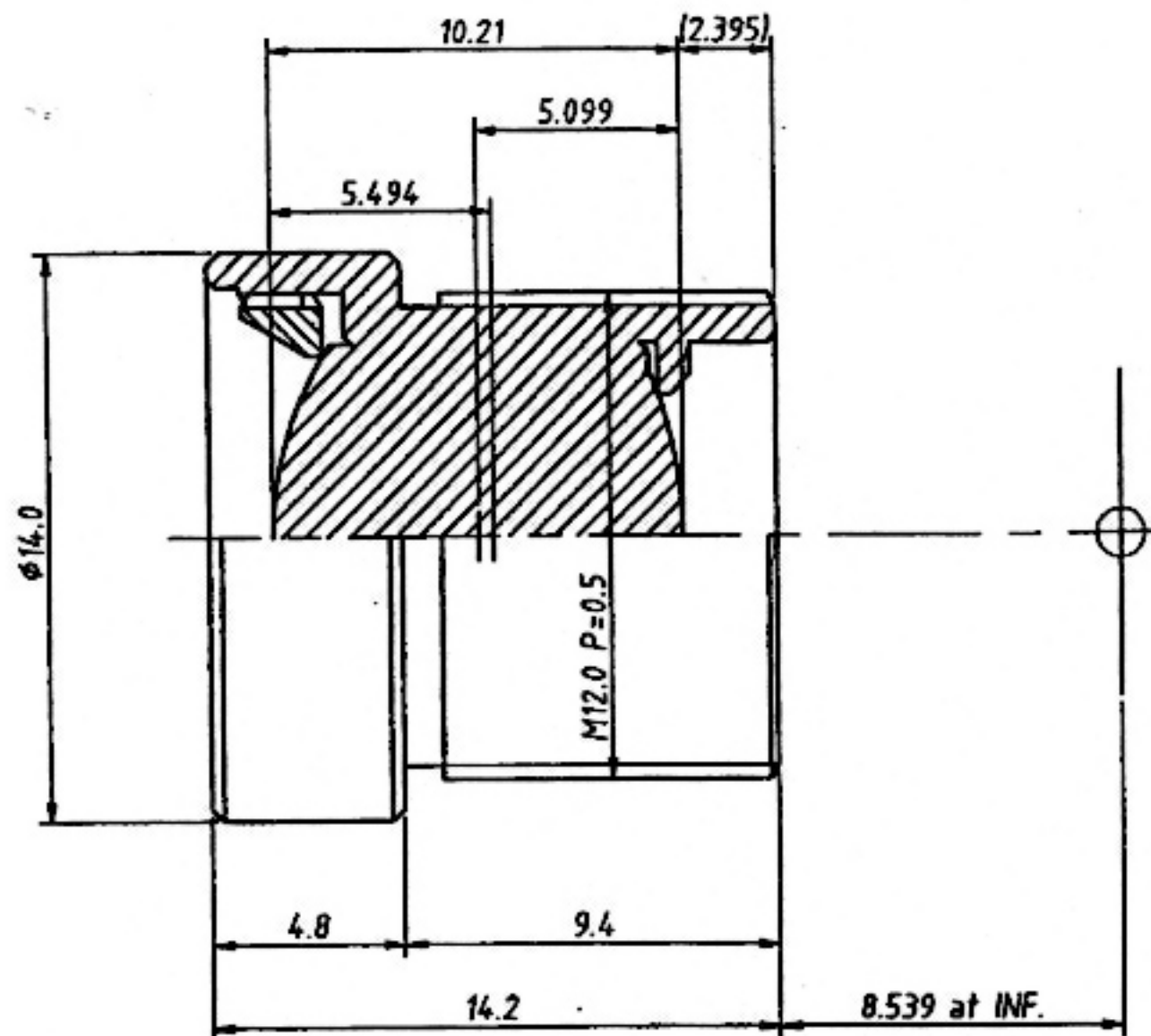

UNIVERSE KOGAKU (AMERICA), INC.
116 Audrey Avenue, Oyster Bay, New York 11771
Phone: (516) 624-2444/Fax: (516) 624-3109

④		TITLE	16mm F/1.8 CCD LENS
③		P/NO.	VL-1618
②		Mfg. NO.	
①	1/21/04		SHEET 1 OF 1 REV A