

Lens Specification	
Focal length	50.00mm ±5%
Back focal length	15.36mm ±5%
Mechanical back	7.10mm ±0.5mm at INF.
Aperture ratio	F/3.8 ±5%
Image size	2/3" CCD (6.6X8.8)
Magnification	-
Distortion	-0.08% (W.D.=200mm)
Angle of view at INF.	
Vertical	7.5°
Horizontal	10.0°
Diagonal	12.4°
Resolution (W.D.=200mm)	
Center	100LP/mm
Corner	80LP/mm
Pupil positions from the lens surface.	
Entrance pupil	0.00mm (Front lens)
Exit pupil	-57.48mm (Image plane)
Principal points from the lens surface.	
Object space	6.50mm (Front lens)
Image space	-50.00mm (Image plane)
Coating (λ =546nm)	
All surfaces are antireflection coated. MgF2 single coated.	

Note:

- |                       |                    |
|-----------------------|--------------------|
| 1. 1/3" CCD (3.6X4.8) | 1/2" CCD (4.8X6.4) |
| Vertical : 4.1°       | Vertical : 5.5°    |
| Horizontal : 5.5°     | Horizontal : 7.3°  |
| Diagonal : 6.8°       | Diagonal : 9.1°    |

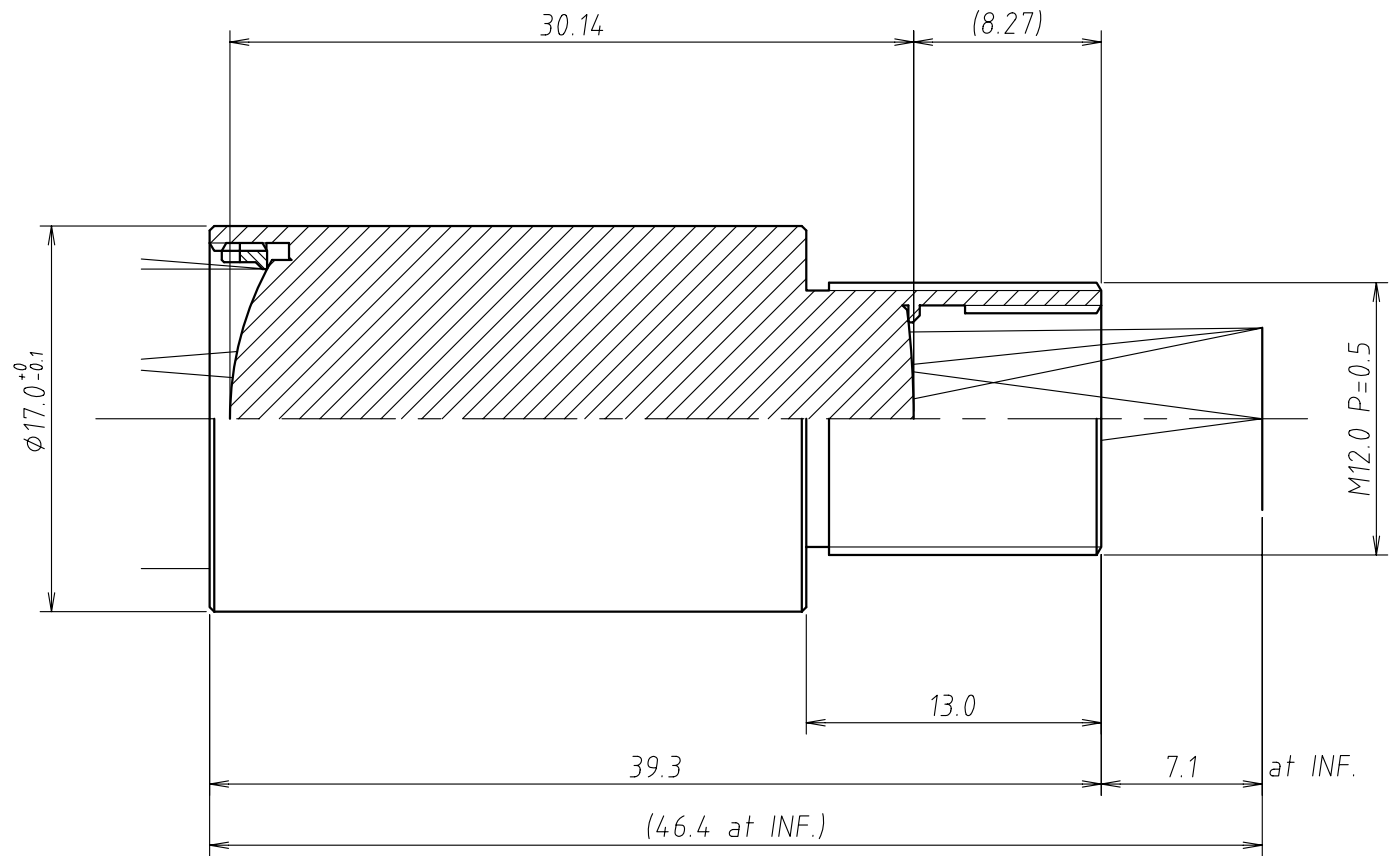

△			TITLE	50mm F/3.8 CCD LENS		
△			P/NO.	VH500D		
△			Mfg.NO.	VH500D-Y01-0	SHEET 1 OF 1	REV A
△						
	12/16/2010					



UNIVERSE KOGAKU (AMERICA), INC.

116 Audrey Avenue, Oyster Bay, New York 11771  
Phone: (516)624-2444/Fax: (516)624-3109