

Lens Specification	
Focal length	11.565mm $\pm 5\%$
Back focal length	8.607mm $\pm 5\%$
Mechanical back	3.6mm ± 0.3 mm at INF.
Aperture ratio	F/4.0 $\pm 5\%$
Image size	$\phi 11.76$ (5.882X9.4)
Magnification	-
Distortion	+0.7%
Angle of view at INF.	
Vertical	28.5°
Horizontal	44.1°
Diagonal	53.6°
Resolution	
Center	63LP/mm
Corner	32LP/mm
Pupil positions from the lens surface.	
Entrance pupil	4.122mm (Front lens)
Exit pupil	-10.524mm (Image plane)
Principal points from the lens surface.	
Object space	2.979mm (Front lens)
Image space	-11.565mm (Image plane)
Coating ($\lambda = 546$ nm)	
All surfaces are antireflection coated. MgF2 single coated.	

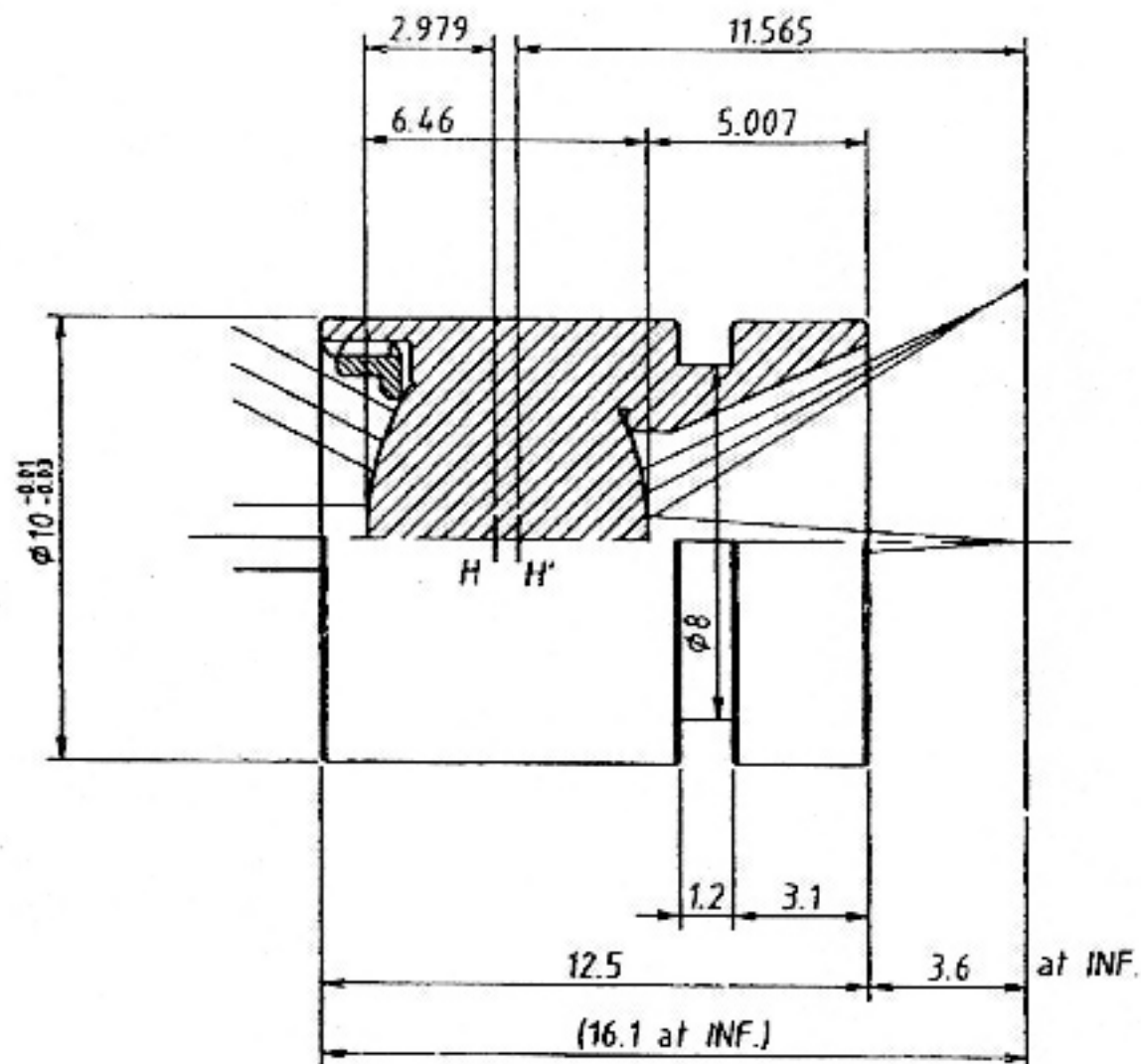

UNIVERSE KOGAKU (AMERICA), INC.

116 Audrey Avenue, Oyster Bay, New York 11771
Phone: (516) 624-2444/Fax: (516) 624-3109

④		TITLE	12mm F/4.0 LENS
③		P/NO.	TS-12
②		Mfg. NO.	
①	09/29/06		
		SHEET 1 OF 1	REV A