

Lens Specification ($\lambda = 266\text{nm}$)	
Focal length	25.04mm±5%
Back focal length	22.07mm±5%
Mechanical back	17.526mm
Aperture ratio	F/2.8±5%
Image size	$\phi 16$ (9.6mmX12.8mm)
Magnification	-
Distortion	-4.05%
Angle of view at INF.	
Vertical	22.2°
Horizontal	29.7°
Diagonal	37.2°
Resolution	
Center	63LP/mm
Corner	20LP/mm
Pupil positions	
Entrance pupil	8.96mm (Front lens)
Exit pupil	-25.87mm (Image plane)
Principal points	
Object space	10.02mm (Front lens)
Image space	-25.04mm (Image plane)
Coating ($\lambda = 266\text{nm}$)	
All surfaces are antireflection coated. MgF2 single coated.	

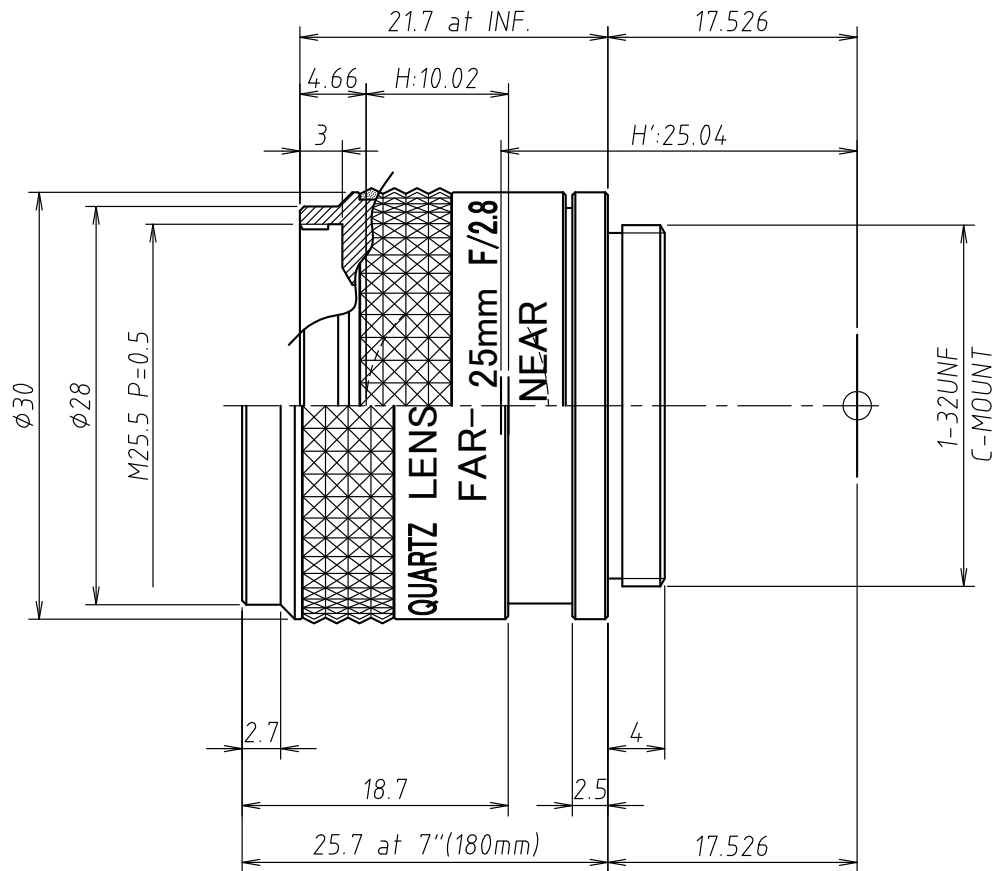

Note:

1. Lens construction:
3group 3element (all QUARTZ LENS)



UNIVERSE KOGAKU (AMERICA), INC.

116 Audrey Avenue, Oyster Bay, New York 11771
Phone: (516)624-2444/Fax: (516)624-3109

\triangle		TITLE	25mm,F/2.8 UV LENS
\triangle		P/NO.	UV2528
\triangle	03/26/2012	Mfg.NO.	VC290A-Y01-0
		SHEET	1 OF 1
		REV	A